

# Soils Map

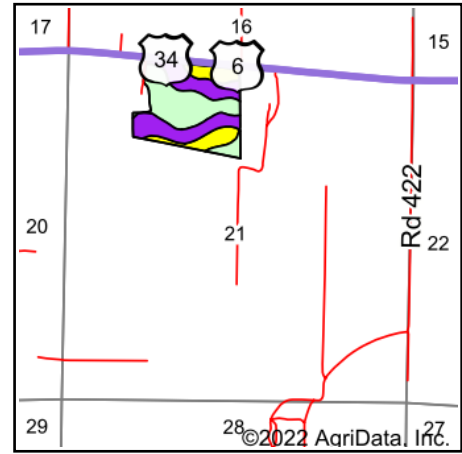

State: **Nebraska**  
 County: **Furnas**  
 Location: **21-4N-23W**  
 Township: **Arapahoe**  
 Acres: **44.29**  
 Date: **9/23/2022**

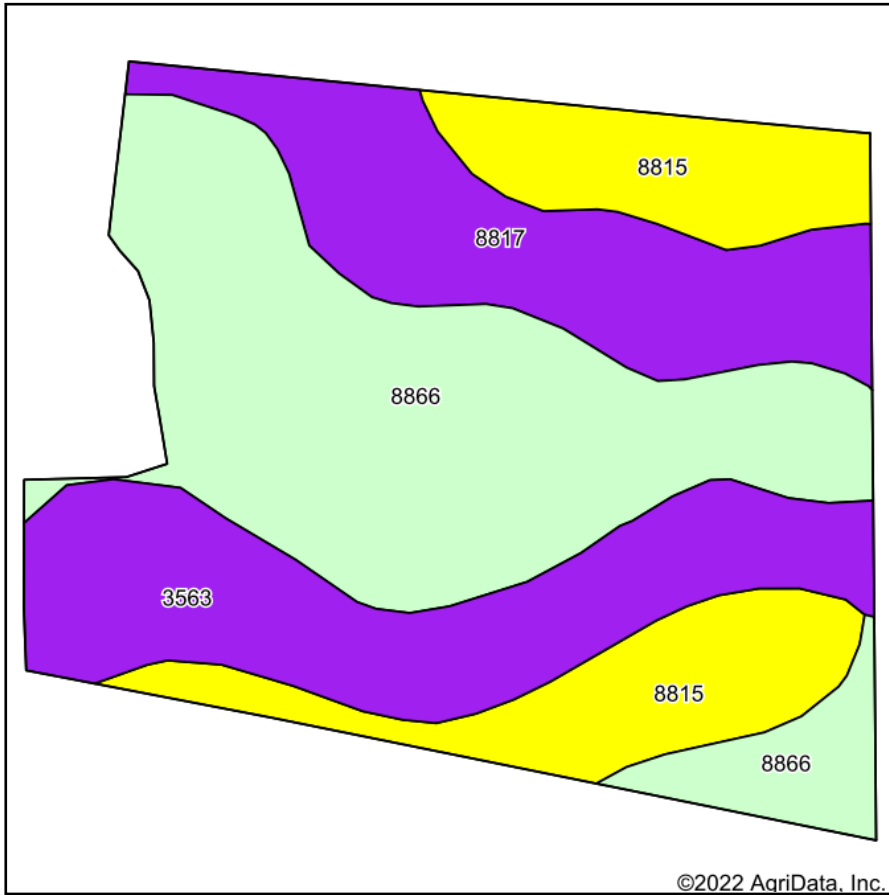

Soils data provided by USDA and NRCS.

Area Symbol: NE065, Soil Area Version: 20

| Code                    | Soil Description                              | Acres | Percent of field | SRPG Legend | Non-Irr Class *c | Irr Class *c | Range Production (lbs/acre/yr) | SRPG        | Corn Bu     | Corn Irrigated Bu | Grain sorghum Bu | Grain sorghum Irrigated Bu | Winter wheat Bu | *n NCCPI Soybeans |
|-------------------------|---|-------|------------------|-------------|------------------|--------------|--------------------------------|-------------|-------------|-------------------|------------------|----------------------------|-----------------|-------------------|
| 8866                    | Hord silt loam, 0 to 1 percent slopes, warm   | 18.10 | 40.9%            |             | llc              | le           | 3762                           |             |             |                   |                  |                            |                 | 79                |
| 3563                    | Hobbs-McCook silt loams, occasionally flooded | 9.40  | 21.2%            |             | llw              | llw          | 4500                           | 59          |             |                   |                  |                            |                 | 64                |
| 8815                    | Cozad silt loam, 0 to 1 percent slopes        | 8.72  | 19.7%            |             | llc              | l            | 4455                           | 63          | 67          | 152               | 73               | 131                        | 49              | 62                |
| 8817                    | Cozad silt loam, 3 to 6 percent slopes        | 8.07  | 18.2%            |             | llc              | l            | 3188                           | 60          |             |                   |                  |                            |                 | 70                |
| <b>Weighted Average</b> |   |       |                  |             | <b>2.00</b>      | <b>1.21</b>  | <b>3950.5</b>                  | <b>35.9</b> | <b>13.2</b> | <b>29.9</b>       | <b>14.4</b>      | <b>25.8</b>                | <b>9.6</b>      | <b>*n 70.8</b>    |

\*n: The aggregation method is "Weighted Average using all components"

\*c: Using Capabilities Class Dominant Condition Aggregation Method

Soils data provided by USDA and NRCS.