

Soils Map

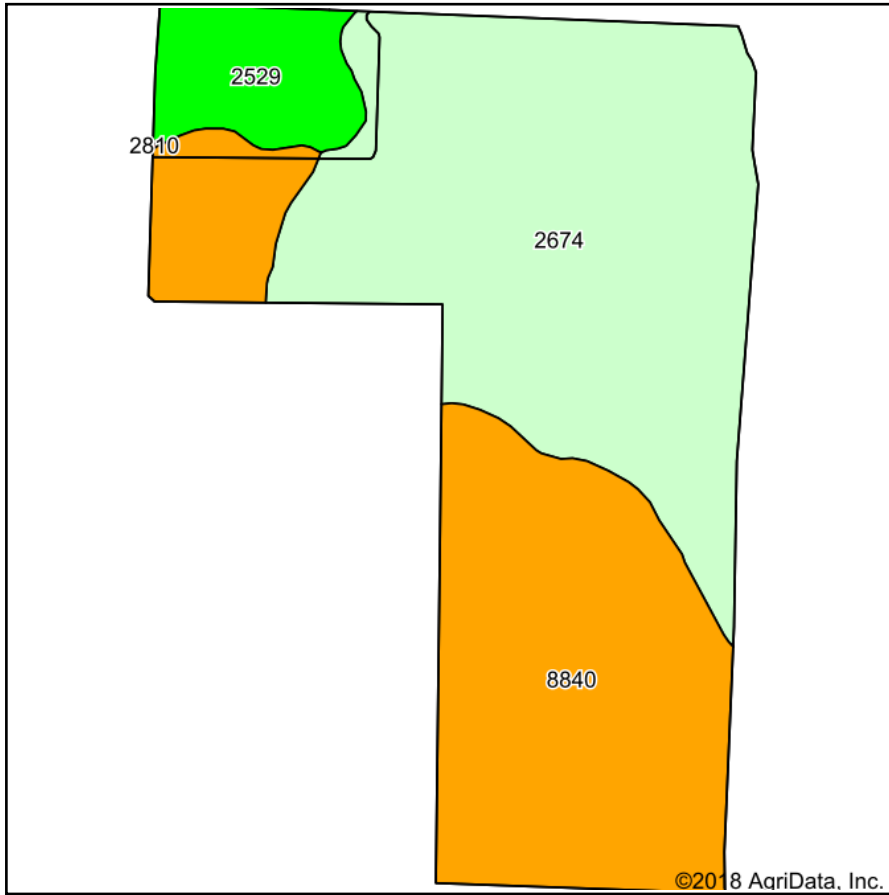

Soils data provided by USDA and NRCS.

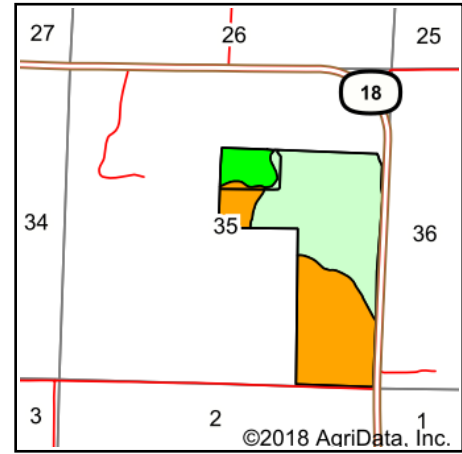

State: **Nebraska**
 County: **Frontier**
 Location: **35-7N-26W**
 Township: **Horrell**
 Acres: **160.15**
 Date: **6/27/2018**

Maps Provided By:



Area Symbol: NE063, Soil Area Version: 15

Code	Soil Description	Acres	Percent of field	SRPG Legend	Non-Irr Class *c	Irr Class *c	Range Production (lbs/acre/yr)	SRPG	Corn	Corn Irrigated	Grain sorghum	Winter wheat	
2674	Holdrege silt loam, 1 to 3 percent slopes, plains and breaks	82.61	51.6%		Ile	Ile	3468						
8840	Hall silt loam, 0 to 1 percent slopes	65.25	40.7%		Ilc	Iw	3470	71	46	139	45	40	
2529	Coly and Uly silt loams, 11 to 30 percent slopes	12.29	7.7%		Vle		2975	34					
Weighted Average								3431	31.5	18.7	56.6	18.3	16.3

*c: Using Capabilities Class Dominant Condition Aggregation Method

Soils data provided by USDA and NRCS.